

Premium stainless steel fillable pressure gauge



Product features:

- Stainless steel 316/316L/Monel wetted parts
- 1% accuracy (0.5% optional)
- Connection and case welded
- Ingress protection IP 67
- Silicone, glycerine or halocarbon filling available
- Wide choice of pressure ranges
- For harsh and corrosive environments and pressure media
- Range of associated accessories available
- **Brannan** quality and accuracy

Applications:

- Chemical and petrochemicals
- Heating, ventilation, air-conditioning
- Food and beverage industry
- Machine and apparatus construction
- Pumps, compressors, hydraulic presses
- High humidity installations
- Oil and gas
- Pulp and paper industry
- Pneumatics
- Hydraulics
- Outdoor installations

Standard product specifications:

Standards & categories	
Design	BS EN 837 / ASME B40.100
Safety category	S1 (blow-out device gauge) (63mm: 0 - no bow-out device)
Gauge construction	
Case	Stainless steel 304 (316 available on request)
Connection orientation	Bottom, lower back or centre back
Connection material	Stainless steel 316 welded to case (optional SS 316L, Monel or Hastelloy-C276)
Bezel	Stainless steel 304 bayonet bezel
Pointer	63mm: black aluminium, others: black aluminium micro adjustable
Measuring principle	Bourdon tube stainless steel 316 (optional SS 316L, Monel or Hastelloy-C276)
Movement	Stainless steel 304
Window	Tempered safety glass (laminated safety glass optional)
Ranges & parameters	
Dial diameters	63mm (2.5"), 100mm (4"), 115mm (4.5") & 150mm (6")
Ranges	-1 to 24 bar & -15 to 350 psi through to 0 to 2500 bar & 0 to 36000 psi
Thread size	1/8", 1/4", 3/8" & 1/2" BSP/NPT/BSPT (others available on request)
Accuracy class	63mm: 1.6%, 100mm, 115mm & 150mm: 1.0% (0.5% optional)
Filling	Dry, glycerine, silicone or halocarbon
Working pressure	Steady: 75% full scale range, fluctuating: 60% full scale range, short time: full scale range
Operating temperature	Ambient: -40 to +60°C (dry, silicone filled or halocarbon filled), -7 to +60°C (glycerine filled) Medium: -40 to +200°C (dry), -10 to +100°C (silicone filled or halocarbon filled), -7 to +60°C (glycerine filled)
Storage temperature	-40 to +60°C
Protection	IP 67
Temperature effect	When temperature of the pressure element deviates from reference temperature of 20°C the maximum additional error is +/-0.4 per 10°C of the span rising and falling
Optional extras	
Calibration	UKAS certification, certificate traceable to recognised national standard or statement of conformity
Accessories	Syphon, needle valve, gauge cock, snubber

Premium stainless steel fillable pressure gauge

Max working pressure per connection type
(for SS 316 material):

Thread	Max pressure
1/8" BSP/NPT	400 bar
1/4" BSP/NPT	1000 bar
3/8" BSP	1000 bar
1/2" BSP	1600 bar
1/2" NPT	1000 bar
9/16-18 UNF-2B (F)	2500 bar

Dimensions:

Bottom entry

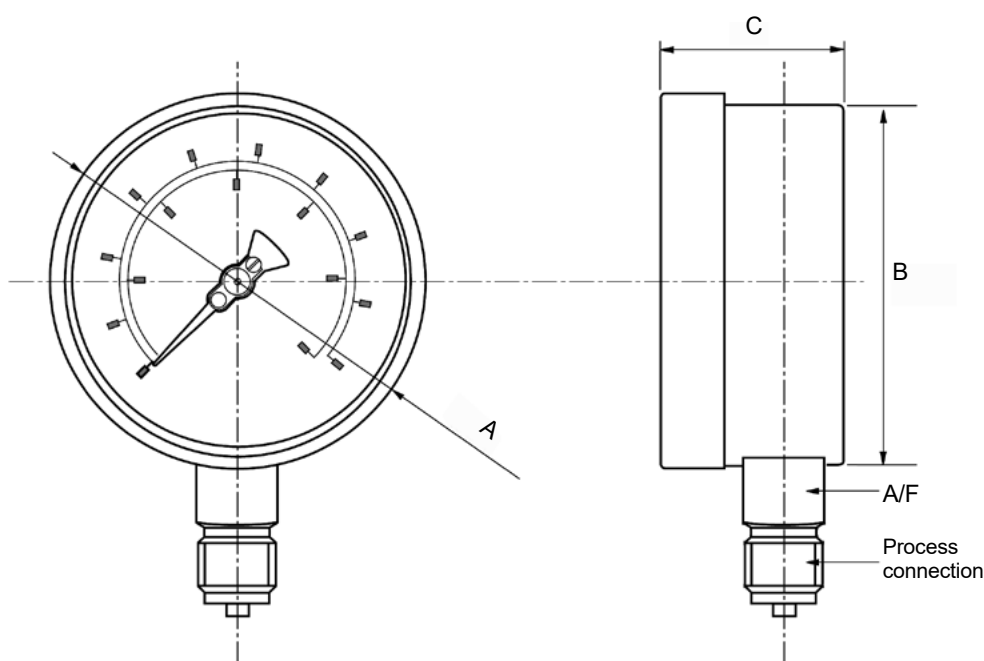

Back entry

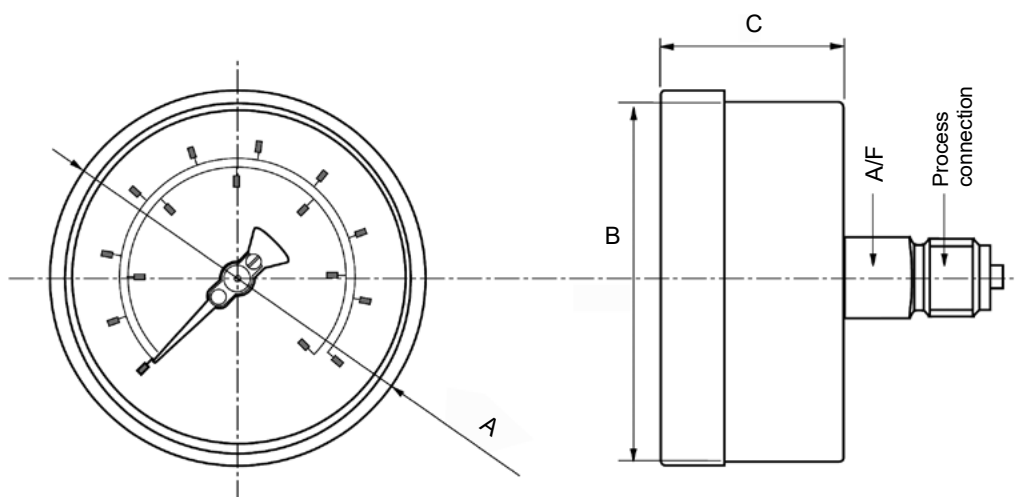

Dial diameter	ØA	ØB	C
63mm (2.5")	68.6mm	61.6mm	33.0mm
100mm (4.0")	109.0mm	95.5mm	49.0mm
115mm (4.5")	127.0mm	114.5mm	49.0mm
150mm (6.0")	166.0mm	152.0mm	49.0mm

Premium stainless steel fillable pressure gauge

Product numbers:

The following PG040 pressure gauges are usually kept in stock at Brannan and can therefore be ordered on the below numbers. These gauges are all 1/2" BSP bottom connection.

The following PG040 pressure gauges are bar dominant:
Bar outer scale - black
psi inner scale - red

Range	Ø100mm (4.0")	
	Dry	Glycerine filled
0 to 6 bar & psi	37/893/0	37/893/5
0 to 10 bar & psi	37/894/0	37/894/5
0 to 16 bar & psi	37/895/0	37/895/5

The following PG040 pressure gauges are psi dominant:
psi outer scale - red
Bar inner scale - black

Range	Ø100mm (4.0")		Ø115mm (4.5")		Ø150mm (6.0")	
	Dry	Gly. filled	Dry	Gly. filled	Dry	Gly. filled
0 to 160 psi & bar	35/405/1	35/405/5	35/435/1	35/435/5	35/465/1	35/465/5
0 to 230 psi & bar	35/406/1	35/406/5	35/436/1	35/436/5	35/466/1	35/466/5
0 to 300 psi & bar	35/407/1	35/407/5	35/437/1	35/437/5	35/467/1	35/467/5
0 to 400 psi & bar	35/408/1	35/408/5	35/438/1	35/438/5	35/468/1	35/468/5

Premium stainless steel fillable pressure gauge

Other PG040 dials are ordered to specific customer specifications. Please use matrix below to create your unique ordering product reference.

Make	Model	Dial diameter	Ranges	Units	Connection size	Connection orientation	Filling	Extras
Brannan (BRN)	PG040 (PG40)	63mm (2.5") (63)	-1 to 24 bar (-1+24)	Bar only (black) (B)	1/8" BSP ₁ (1) 1/8" NPT ₁ (2)	Bottom (BO)	Dry No filling (D)	Laminated safety glass window (LG)
		100mm (4.0") (100)	-30 to 350 Hg/Psi (-30+350)	Psi only (black) (P)	1/4" BSP ₁ (3) 1/4" NPT ₁ (4)	Centre back ₁ (CB)	Glycerine (G)	Front flange (FF)
		115mm (4.5") (115)	through to	Bar outer (black) / psi inner (red) (BP)	3/8" BSP ₂ (5) 3/8" NPT ₂ (6)	Lower back (LB)	Silicone (S)	Back flange (BF)
		150mm (6.0") (150)	0 to 2500 bar (0+2500) 0 to 36250 Psi (0+36250)	Psi outer (red) / bar inner (black) (PB)	1/2" BSP ₂ (7) 1/2" NPT ₂ (8)		Halocarbon (H)	U clamp (UCL)
				kPa outer (black) / Psi inner (red) (KP)	1/8" BSPT ₁ (9) 1/4" BSPT ₁ (10) 3/8" BSPT ₂ (11) 1/2" BSPT ₂ (12) M20 x 1.5 ₂ (13) 9/16-18 UNF-2B (Female) (20)			316L wetted parts (316L)
				Psi outer (red) / kPa inner (black) (PK)				Monel wetted parts (MON)
				Megapascals (black) (MPA)				Hastelloy-C276 wetted parts (HAS)
								0.5% accuracy (0.5%)
								Materials test certificate (MTC)
								NB. When more than one extra is required, please separate each code with a hyphen when building your product reference
				NB. Others available on request	1. 63mm only 2. 100mm, 115mm & 150mm only NB. Others available on request	1. CB 63mm only		

Order example:

Make	Model	Dial diameter	Ranges	Units	Connection size	Connection orientation	Filling	Extras
BRN	PG40	100	0+10	B	7	BO	D	LG-FF

Product reference: BRNPG40/100/0+10/B/7/BO/D/LG-FF

Calibration product numbers:

Other calibration types available on request

Calibration	No of points	Product number
UKAS	5pt	49/075/0
Traceable to National Standards	5pt	49/060/0