

# XT020

## Commercial liquid expansion dial thermometer

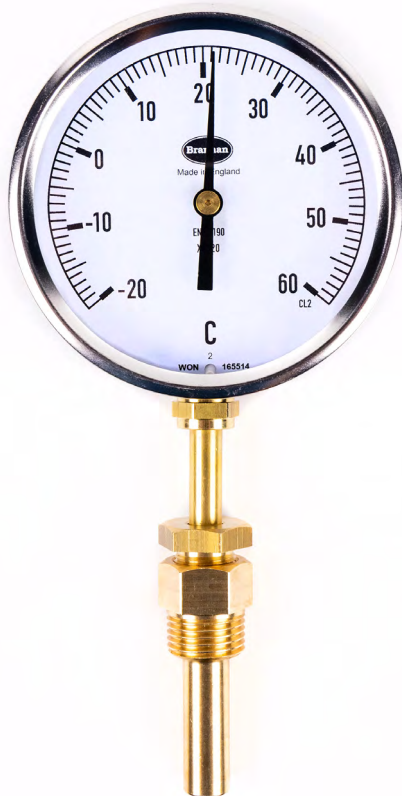

### Product features:

- Thermometer with stainless steel bezel and brass stem
- High quality liquid expansion measuring system
- Wide choice of temperature ranges and stem lengths
- Supplied complete with brass pocket
- For dry indoor installations
- Wide range of associated accessories available
- **Brannan** quality and accuracy

### Applications:

- Heating
- Air conditioning
- Refrigeration
- Ventilation

### Standard product specifications:

| XT020                  |  |
|------------------------|--|
| Standards & categories |  |
| Design                 | BS EN 13190  |
| Dial construction      |  |
| Case                   | Black steel  |
| Bezel                  | 304 Stainless steel  |
| Connection orientation | Bottom or back   |
| Pocket material        | Brass (SS 304 or SS316 available on request)   |
| Pointer                | Black plastic  |
| Sensor mechanism       | Liquid expansion (Kerosene filling)  |
| Window                 | PMMA   |
| Stem lengths           | 100mm, 150mm & 200mm   |
| Pocket lengths         | 50mm, 100mm & 150mm  |
| Lagging extensions     | 50mm (100mm lagging extension available on request)  |
| Ranges & parameters    |  |
| Dial diameter          | 100mm (4") & 150mm (6")  |
| Ranges                 | -20 to 60°C and -4 to 140°F through to 0 to 200°C and 0 to 390°F (0 to +250°C only)          |
| Thread size            | 1/2" BSP   |
| Accuracy class         | 2  |
| Filling                | Dry  |
| Protection             | IP 54 (BS EN 60529:1992)   |
| Operating temperature  | 0 to +40°C (higher or lower temperatures can cause indication errors)                        |
| Storage temperature    | -40 to +60°C   |
| Optional extras        |  |
| Calibration            | Certificate traceable to recognised national standard or statement of conformity if required |
| Accessories            | Pockets, self sealing test plugs   |

## Commercial liquid expansion dial thermometer

### Dimensions:

100mm dial thermometer - bottom entry

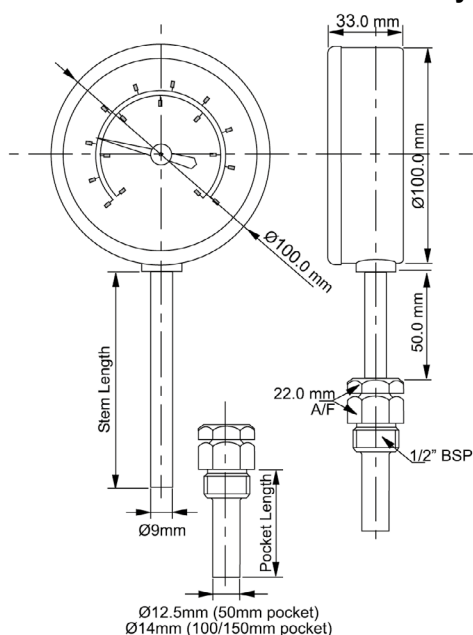

100mm dial thermometer - back entry

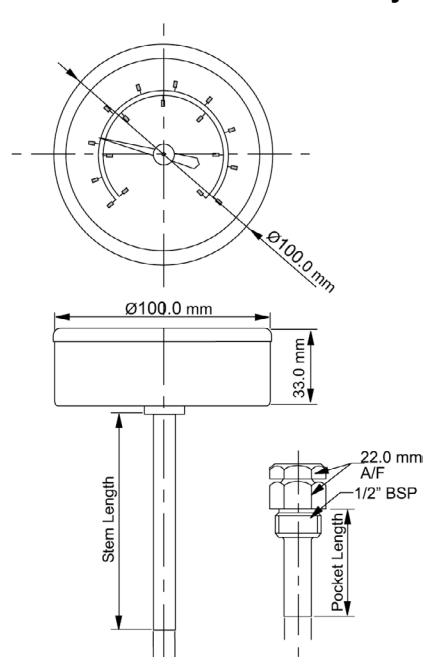

150mm dial thermometer - bottom entry

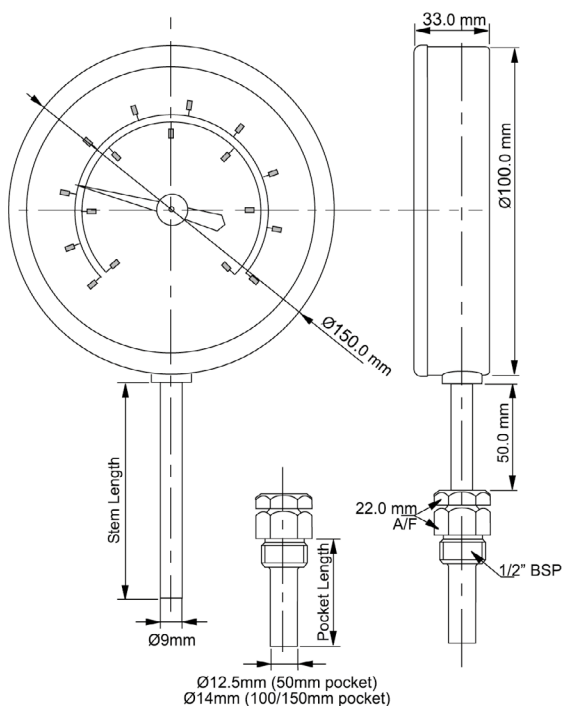

150mm dial thermometer - back entry

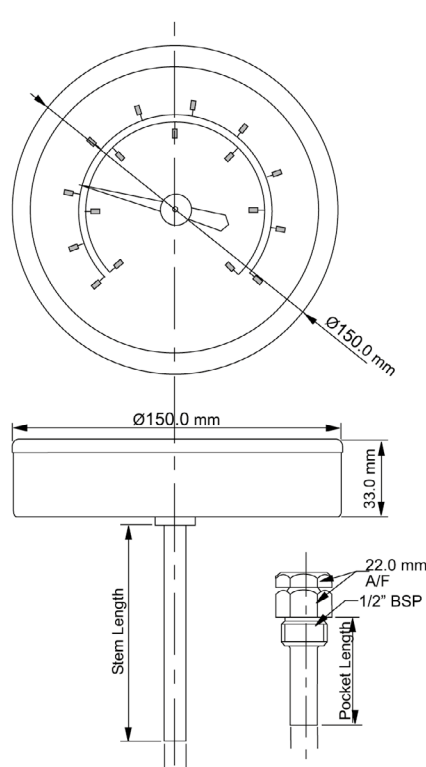

## Commercial liquid expansion dial thermometer

### Standard Product Numbers:

The following are our standard product numbers. Special products can be supplied on request, for example, customer own branding, alternative connection, range, etc. Minimum order quantities apply. Please contact our Sales Team for further information.

| Range             | 100mm Diameter product numbers |                            |                            |                           |                            |                            |
|-------------------|--------------------------------|----------------------------|----------------------------|---------------------------|----------------------------|----------------------------|
|                   | Bottom connection              |                            |                            | Back connection           |                            |                            |
|                   | 100mm Stem<br>50mm Pocket      | 150mm Stem<br>100mm Pocket | 200mm Stem<br>150mm Pocket | 100mm Stem<br>50mm Pocket | 150mm Stem<br>100mm Pocket | 200mm Stem<br>150mm Pocket |
| -40 to +40°C only | 97/621/0                       | 97/641/0                   | 97/661/0                   | 96/621/0                  | 96/641/0                   | 96/661/0                   |
| -40 to +40°C&F    | 97/622/0                       | 97/642/0                   | 97/662/0                   | 96/622/0                  | 96/642/0                   | 96/662/0                   |
| -20 to +60°C only | 97/623/0                       | 97/643/0                   | 97/663/0                   | 96/623/0                  | 96/643/0                   | 96/663/0                   |
| -20 to +60°C&F    | 97/624/0                       | 97/644/0                   | 97/664/0                   | 96/624/0                  | 96/644/0                   | 96/664/0                   |
| 0 to +120°C only  | 97/625/0                       | 97/645/0                   | 97/665/0                   | 96/625/0                  | 96/645/0                   | 96/665/0                   |
| 0 to +120°C&F     | 97/626/0                       | 97/646/0                   | 97/666/0                   | 96/626/0                  | 96/646/0                   | 96/666/0                   |
| 0 to +160°C only  | 97/627/0                       | 97/647/0                   | 97/667/0                   | 96/627/0                  | 96/647/0                   | 96/667/0                   |
| 0 to +160°C&F     | 97/628/0                       | 97/648/0                   | 97/668/0                   | 96/628/0                  | 96/648/0                   | 96/668/0                   |
| 0 to +200°C&F     | 97/630/0                       | 97/650/0                   | 97/671/0                   | 96/630/0                  | 96/650/0                   | 96/670/0                   |
| 0 to +250°C only  | 97/629/0                       | 97/649/0                   | 97/670/0                   | 96/629/0                  | 96/649/0                   | 96/669/0                   |

| Range             | 150mm Diameter product numbers |                            |                            |                           |                            |                            |
|-------------------|--------------------------------|----------------------------|----------------------------|---------------------------|----------------------------|----------------------------|
|                   | Bottom connection              |                            |                            | Back connection           |                            |                            |
|                   | 100mm Stem<br>50mm Pocket      | 150mm Stem<br>100mm Pocket | 200mm Stem<br>150mm Pocket | 100mm Stem<br>50mm Pocket | 150mm Stem<br>100mm Pocket | 200mm Stem<br>150mm Pocket |
| -40 to +40°C only | 97/921/0                       | 97/941/0                   | 97/961/0                   | 96/921/0                  | 96/941/0                   | 96/961/0                   |
| -40 to +40°C&F    | 97/922/0                       | 97/942/0                   | 97/962/0                   | 96/922/0                  | 96/942/0                   | 96/962/0                   |
| -20 to +60°C only | 97/923/0                       | 97/943/0                   | 97/963/0                   | 96/923/0                  | 96/943/0                   | 96/963/0                   |
| -20 to +60°C&F    | 97/924/0                       | 97/944/0                   | 97/964/0                   | 96/924/0                  | 96/944/0                   | 96/964/0                   |
| 0 to +120°C only  | 97/925/0                       | 97/945/0                   | 97/965/0                   | 96/925/0                  | 96/945/0                   | 96/965/0                   |
| 0 to +120°C&F     | 97/926/0                       | 97/946/0                   | 97/966/0                   | 96/926/0                  | 96/946/0                   | 96/966/0                   |
| 0 to +160°C only  | 97/927/0                       | 97/947/0                   | 97/967/0                   | 96/927/0                  | 96/947/0                   | 96/967/0                   |
| 0 to +160°C&F     | 97/928/0                       | 97/948/0                   | 97/968/0                   | 96/928/0                  | 96/948/0                   | 96/968/0                   |
| 0 to +200°C&F     | 97/929/0                       | 97/949/0                   | 97/969/0                   | 96/929/0                  | 96/949/0                   | 96/969/0                   |
| 0 to +250°C only  | 97/930/0                       | 97/950/0                   | 97/970/0                   | 96/930/0                  | 96/950/0                   | 96/970/0                   |

### Calibration product numbers:

| Calibration                        | No of points | Product number |
|------------------------------------|--------------|----------------|
| Traceable to<br>National Standards | 1pt          | 49/099/0       |
|                                    | 3pt          | 49/101/0       |
|                                    | 4pt          | 49/104/0       |
|                                    | 5pt          | 49/105/0       |

Weights and packaging dimensions on request

## Commercial liquid expansion dial thermometer

### APK010 - REPLACEMENT POCKETS FOR THERMOMETERS

#### Use of Thermometer Pockets

Standard pockets, nominal length up to and including 100mm, are suitable for working pressure up to 40 bar. Pockets exceeding 100mm nominal length will normally be fabricated and are only suitable for working pressure of up to 25 bar. Thermometers are normally supplied complete with pockets and should not be installed on a pressurised system without suitable pocket.

#### Product features

- Available in brass or stainless steel
- To suit stem lengths 50mm, 100mm or 150mm

#### Applications

- Heating, ventilation, air-conditioning
- Hot water
- Industrial



| Connection                   | Supplied as standard / on special request | Material        | Product numbers |           |            |         |
|------------------------------|---|-----------------|-----------------|-----------|------------|---------|
|                              |   |                 | L=50mm          | L=100mm   | L=150mm    | L=250mm |
| 1/2" BSP M with nut & O'ring | Standard                                  | Brass           | 39/621/0        | 39/622/0  | 39/623/0   | -       |
| 1/2" BSP M                   | Special request                           | Stainless steel | 39/111/0        | 39/112/0  | 39/113/0   | -       |
| 3/8" BSP M                   | Special request                           | Brass           | 39/121/1        | -         | -          | -       |
| 1/2" BSP M                   | Special request                           | Brass           | -               | 39/160/0* | 39/161/0** | 39123/1 |

\* 50mm + 50mm extension

\*\* 100mm + 50mm extension

#### Personalised instrumentation

As an additional service, we are able to offer full, four colour, logo print on Brannan gauges to personalise your products. Our state of the art printing process enables us to work with you to provide a branded product to enhance your instruments. This service is provided at our UK manufacturing facility and so enables a rapid turnaround (ex-stock gauges). Please contact our sales team for details.



View me on the website

